

DfMA

A consolidated methodology within industrialised production framework

Design for Manufacture and Assembly (DfMA) is a methodology within the industrialised production (IP) framework. It represents a subset of Lean thinking and focuses on optimising the design process to improve manufacturing efficiency and simplify assembly

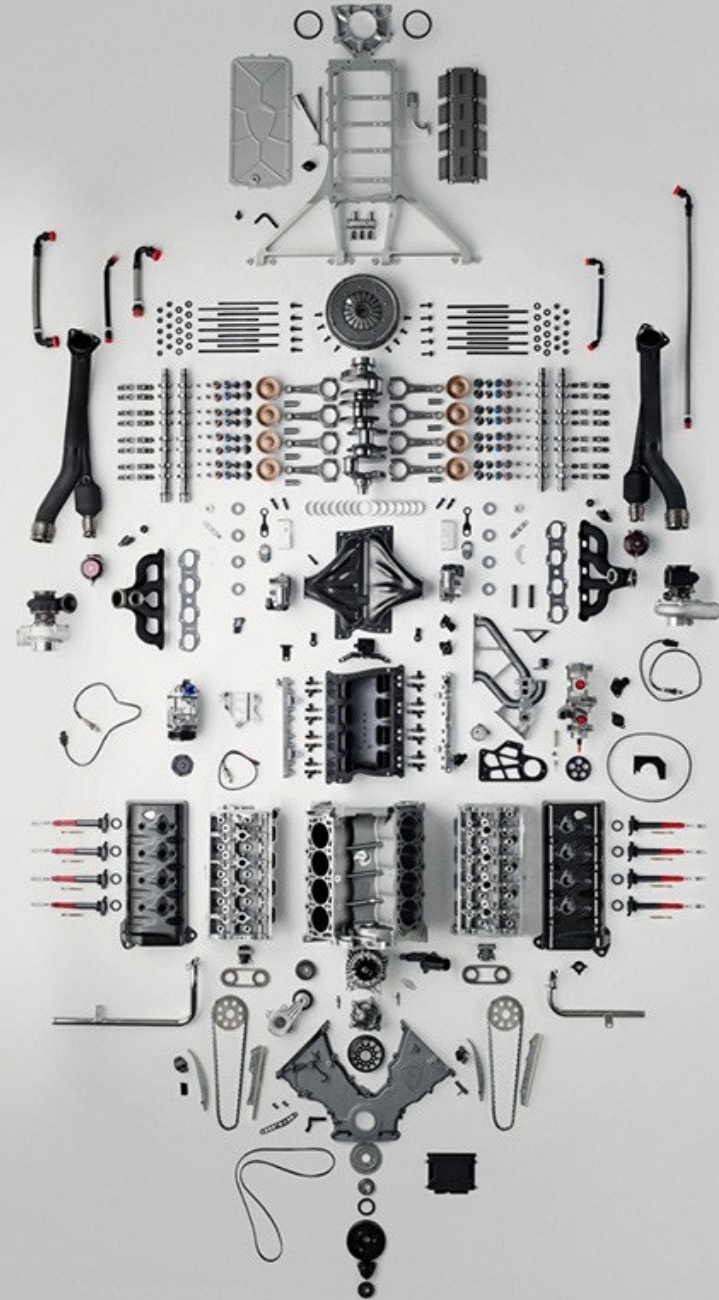
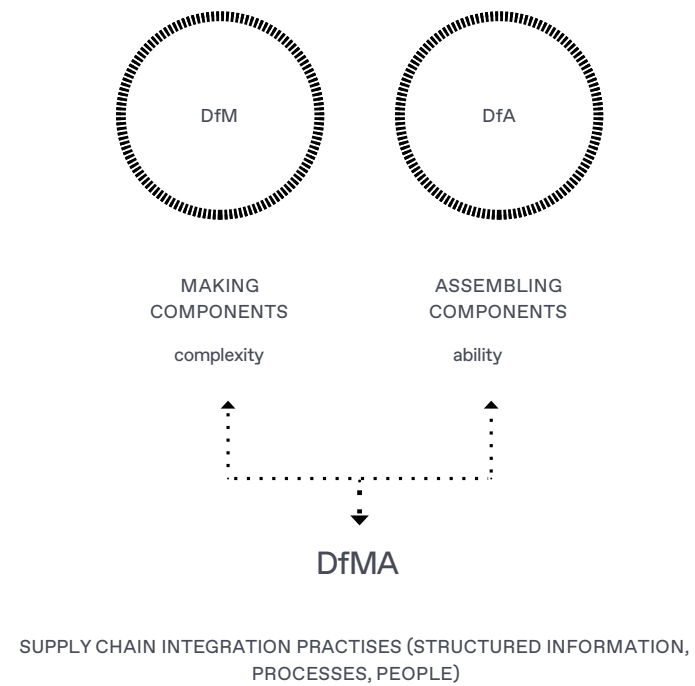

JANE JACOBS

IDEA OF URBAN MIXITE

WHERE THE FUNCTONS SE MIXED

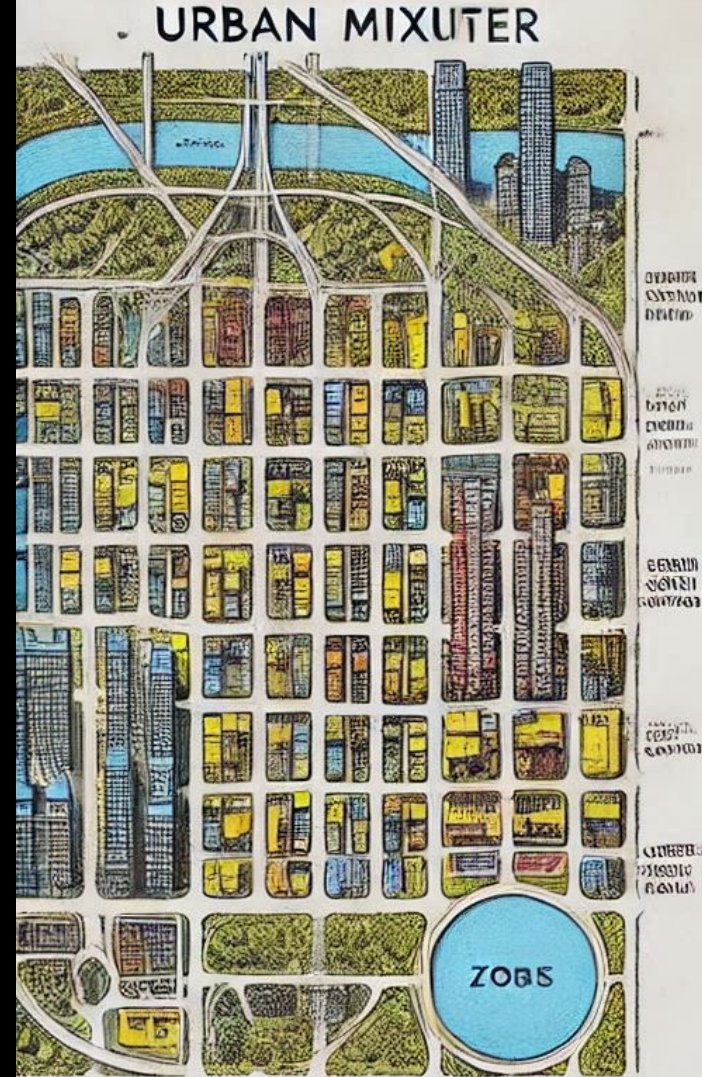

JANE CITY
MONIED

THE FUNCTONS
OF MIXED

LE CORBUSIER'S

OS URBAN MIXITE

WH HE FUNCONS INTO ZONES

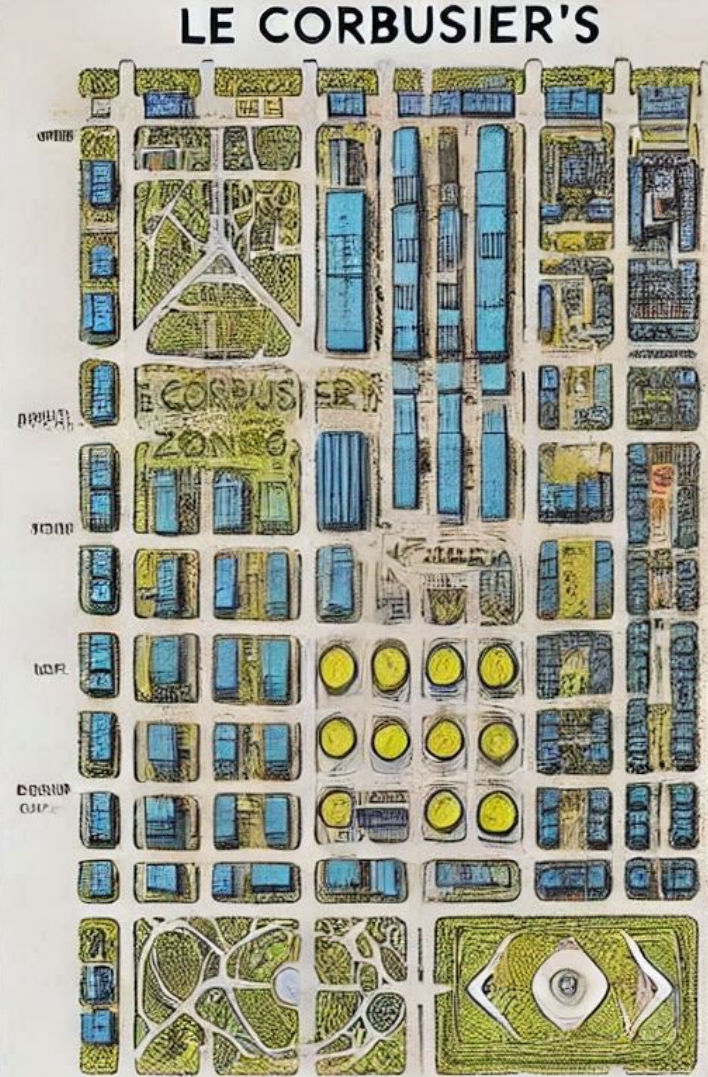

LE CORBUSIER'S
ZONING

LE CORBUSIE
ZONING

Traditional Construction

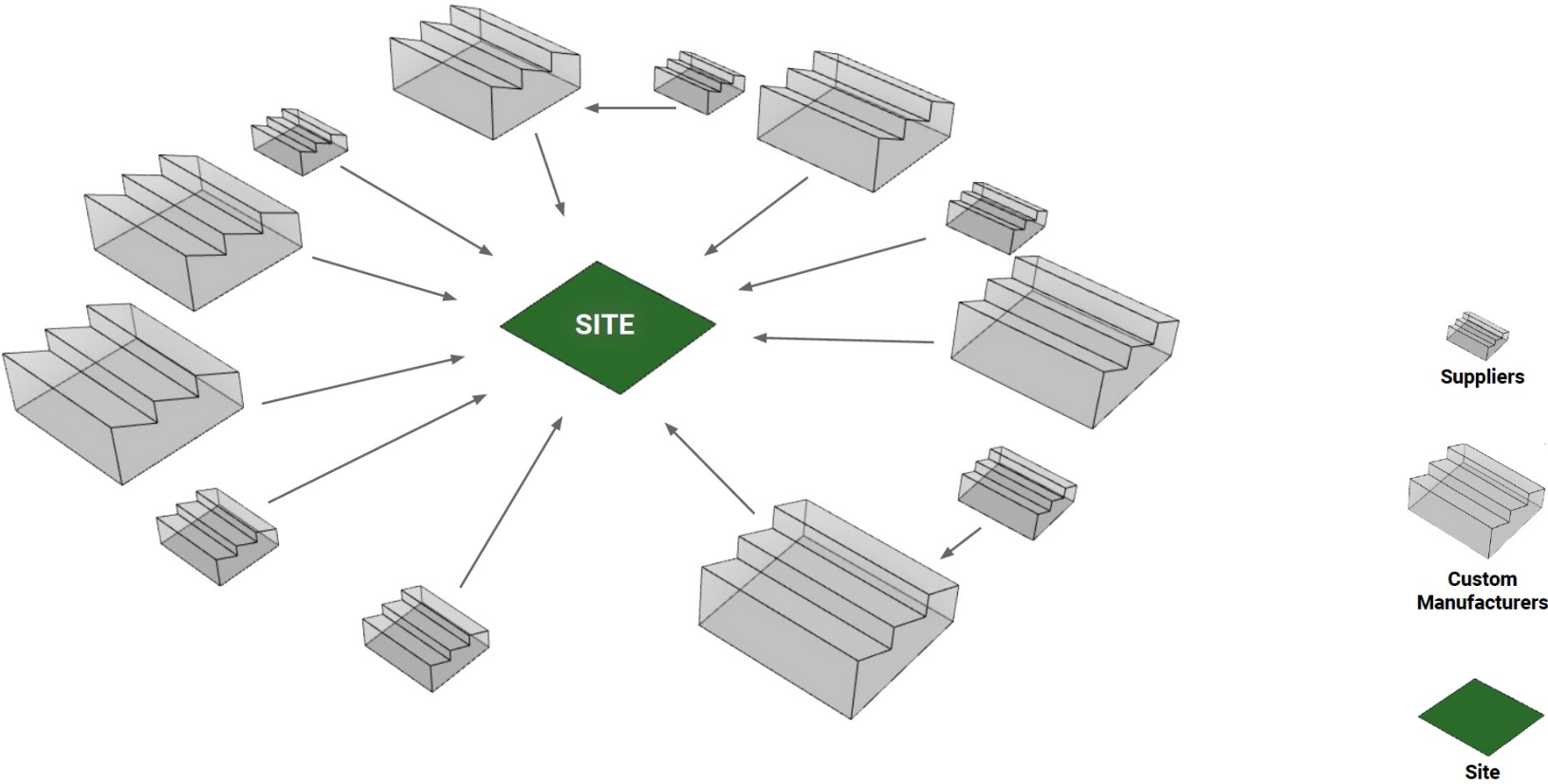

PUBLIC USE

Modular Manufacturing

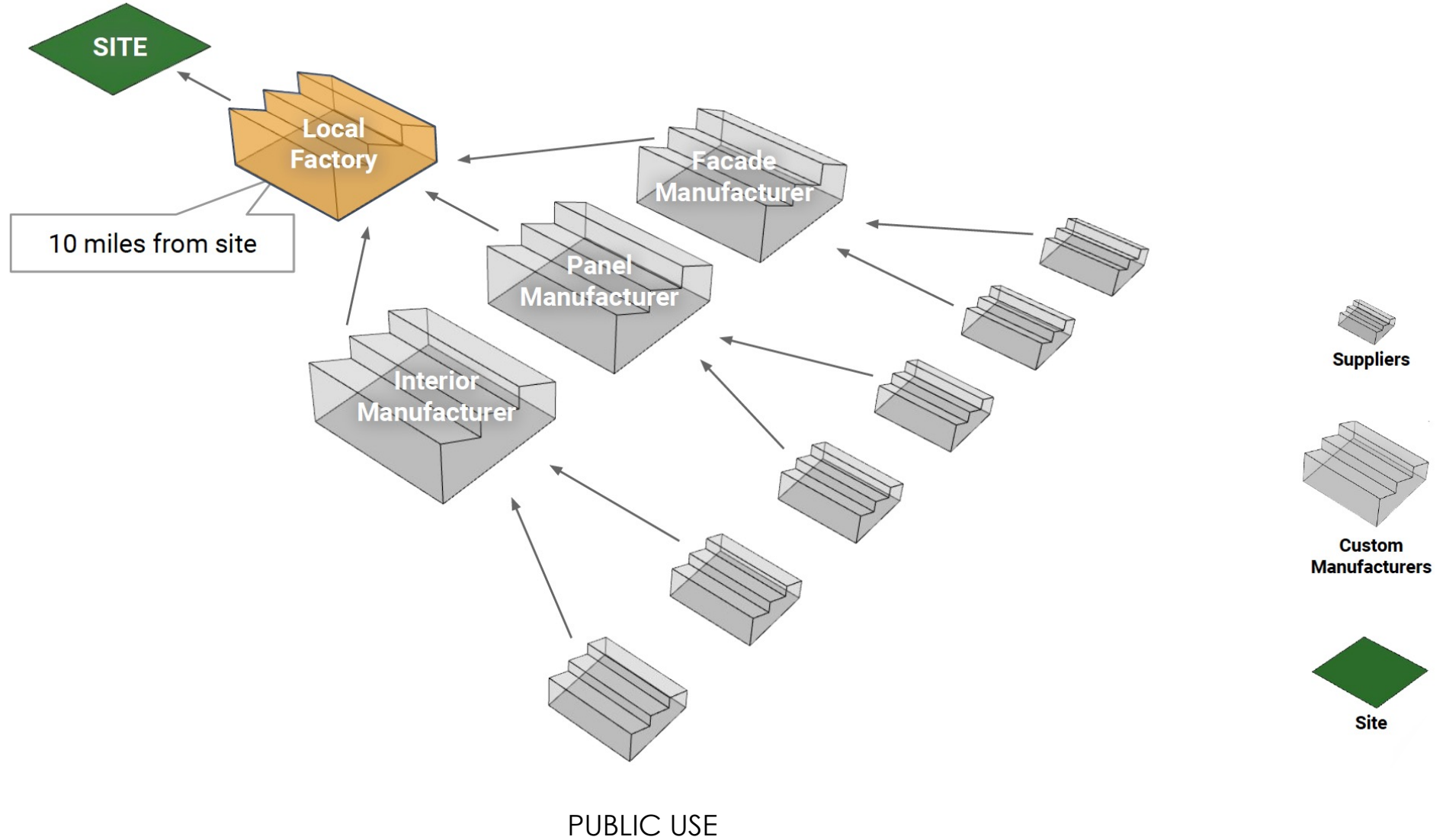

WHAT DOES “COFACTORY” MEAN?

Cofactory means *contemporary laboratory*, where the new microcosm of innovation and creativity will be formed through hybrid spaces for meeting, thinking and acting.

These flexible spaces reflect a new elasticity in the culture of industry and technology, following the current global changes of traditional manufacturing models that are disappearing, impacting the urban and social fabric in the process.



Design Strategy.

Key Approches

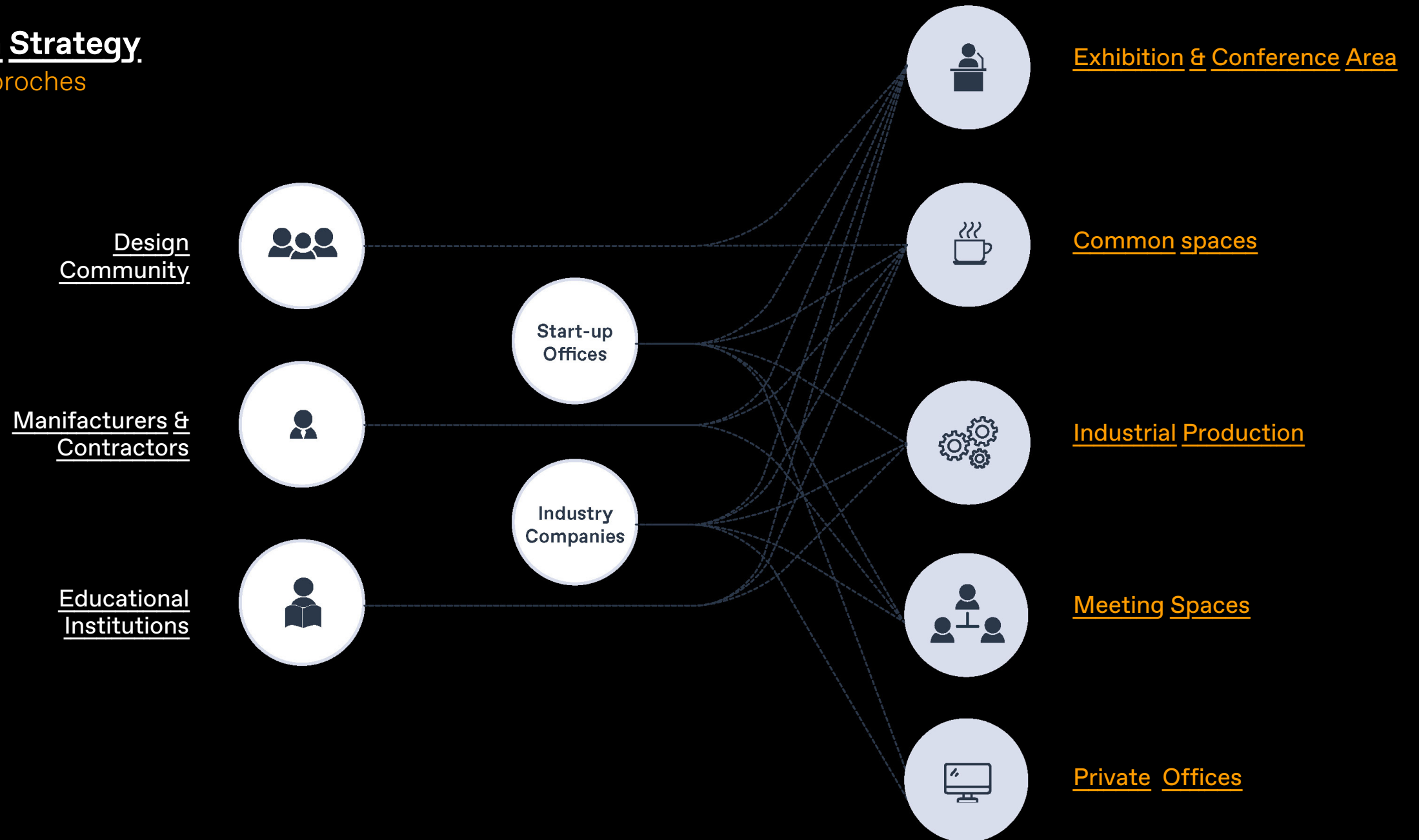

Design Strategy.

Creation of an Ecosystem

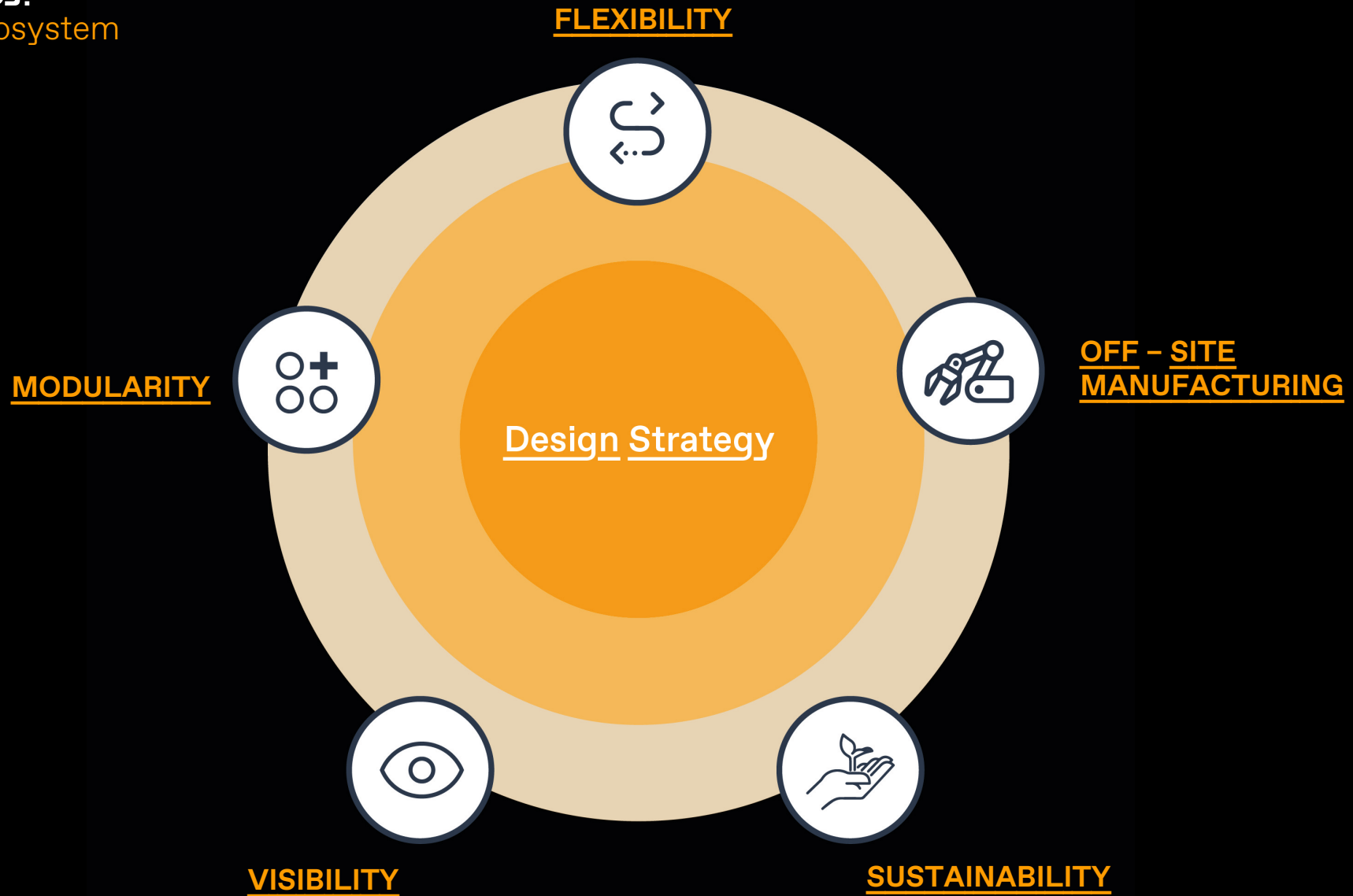



OFFICE

1.5

1.4

1.3

1.1

1.2

LED

MODULE

Intend of Use

Meeting Room

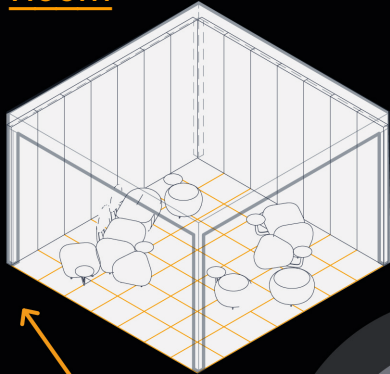

Toilet

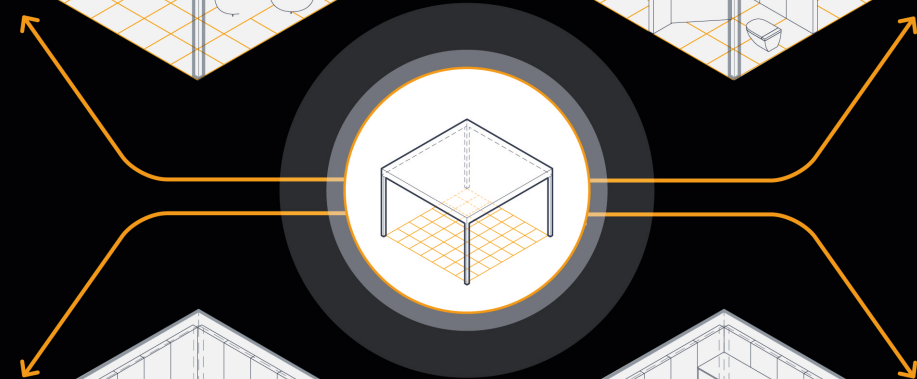
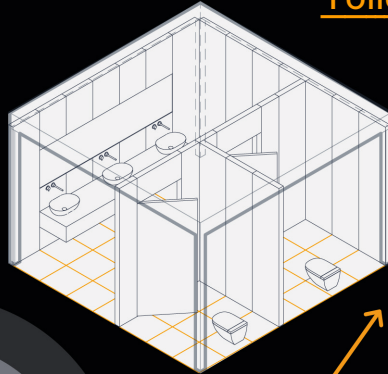

Laboratory

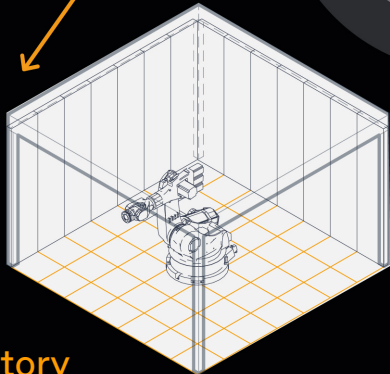

Office

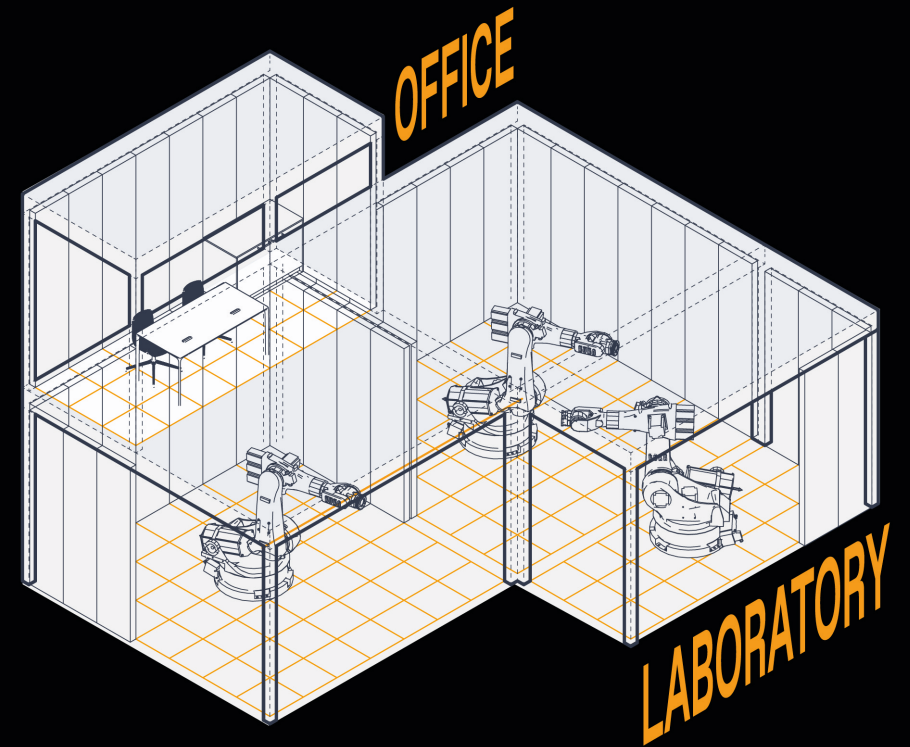

Plan

Ground Floor / Functions

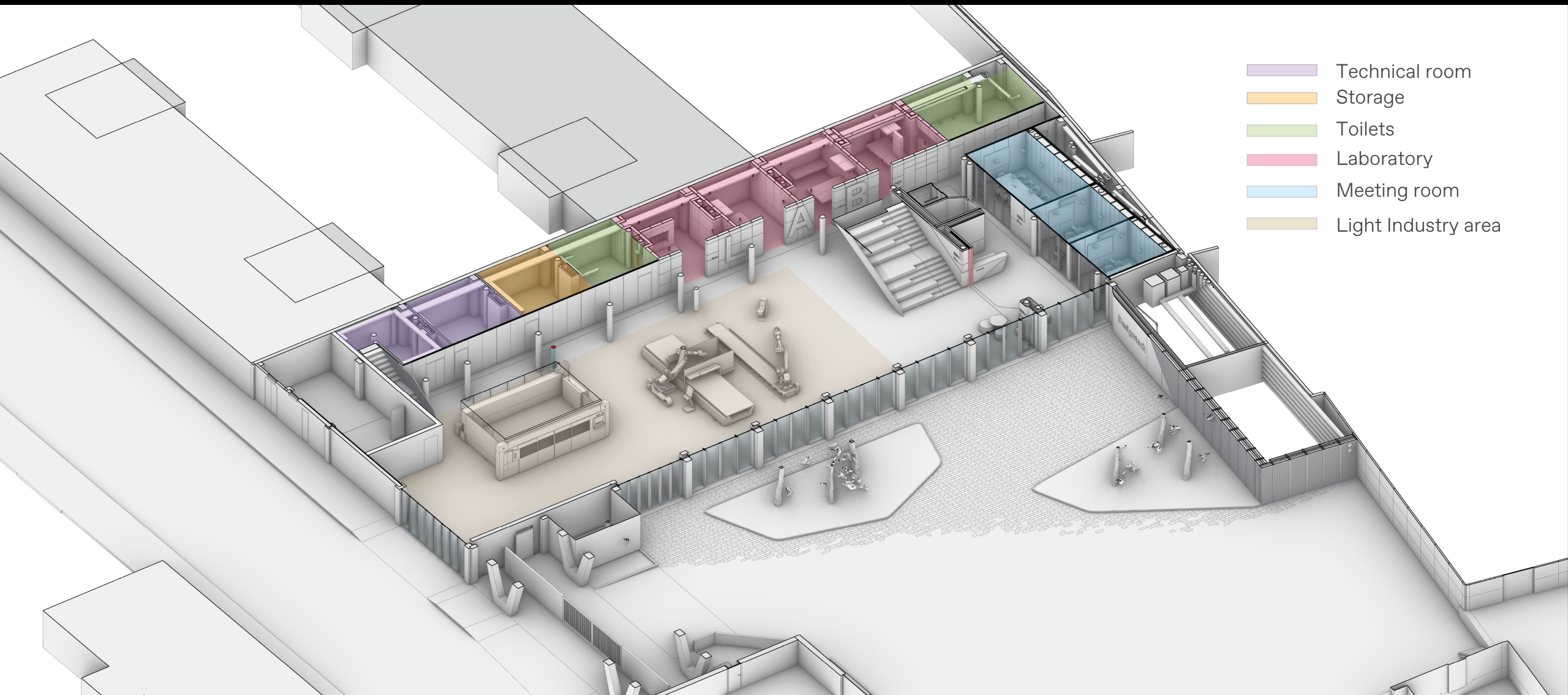

Plan

First Floor / Functions

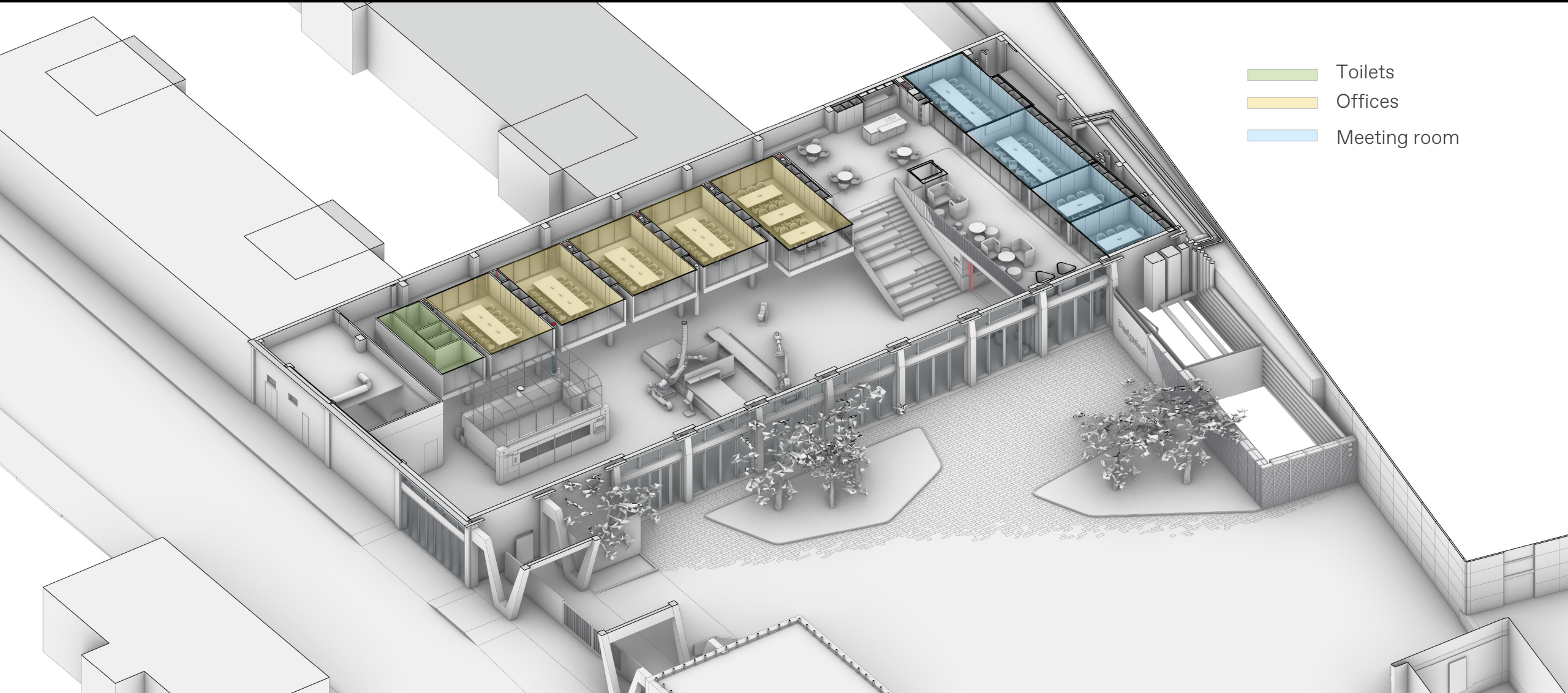

View
Main Elevation



View
Internal View

